

Technical Data Sheet

Product: Geometry Live Line

Category: Acoustic materials

Product Description

Geometry Live Line (GLL) are triangle designer acoustic panels especially created to improve the acoustics in offices, conference halls, hotels and public spaces. The aesthetic value of GLL, combined with its high absorbing parameters make it the perfect acoustic solution for schools and universities, television studios, clubs and more. The sculptural expressiveness of the series, highlighted by artificial or natural light, allows the creation of unique artworks in every treated interior.

GLL series consists of five triangle elements with different inclination-GL1, GL2, GL3, GL4, GL5, which can be combined in countless spectacular geometric and color compositions suitable for different interior needs.

- Optionally treated with fire retardant – class of reaction to fire according to DIN4102 – B1

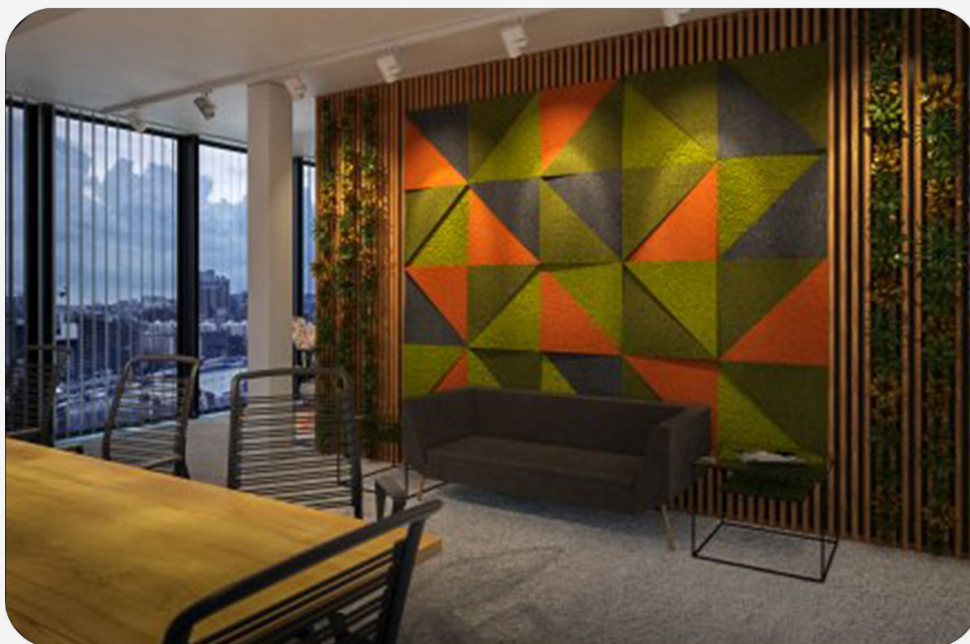
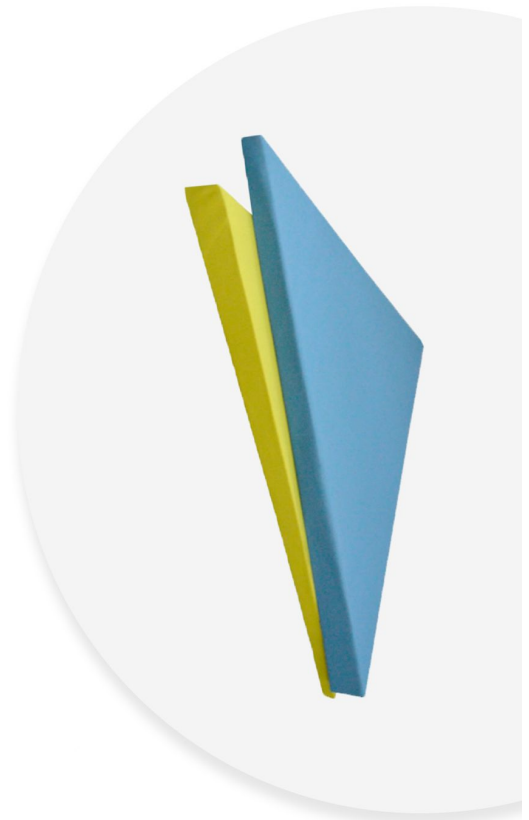

Product Characteristics

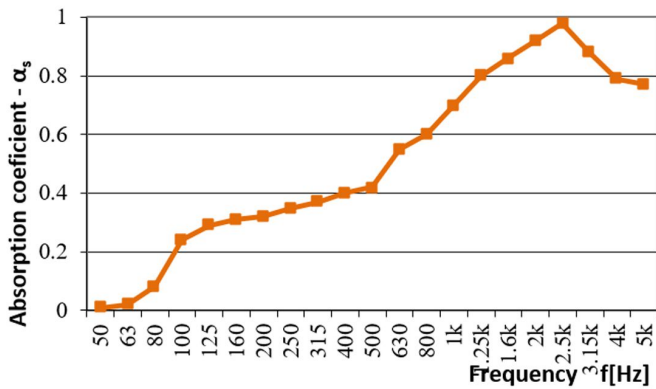

f [Hz]	as	f [Hz]	as
50	0.01	500	0.42
63	0.02	630	0.55
80	0.08	800	0.6
100	0.24	1k	0.7
125	0.29	1.25k	0.8
160	0.31	1.6k	0.86
200	0.32	2k	0.92
250	0.35	2.5k	0.98
315	0.37	3.15k	0.88
400	0.42	4k	0.79

PHYSICAL CHARACTERISTICS	Unit	Value	Tolerance
Thickness	mm	50	±2%
Legs	mm	600	±2%
Base	mm	840	±2%
Weight	kg	0,282	±2%

AVAILABLE COLORS FOR THE TEXTILE



PACKING AND STORAGE

Indoor storage is obligatory for the produces, repaired from rain. Storage in a dry and cool place.